

Corporate Retreats

ONE HISTORIC EXPERIENCE



Normandy Farm

BLUE BELL
Country Club

Contents

2

WELCOME

3

ACCOMODATIONS

4

PROFESSIONALLY
CERTIFIED

6

DAILY MEETING PACKAGES

7-8

CONFERENCE
& MEETING SPACE

9

TESTIMONIALS

10

TEAMBUILDING

Welcome

Normandy Farm's beautiful historic ambiance is the perfect backdrop for a one-of-a kind executive retreat. The detailed preservation of this historic 18th century landmark, with its exposed wood beams, original brick archways and unique architecture was an agricultural wonder of its day. Blue Bell Country Club offers exclusive space for large and small groups and features a classic yet contemporary style.

Of course, time moves on and today's businesses require leading edge solutions for their meeting requirements. With over 30,000 square feet in 17 separate meeting rooms, Normandy Farm features comfortable conference space, numerous breakout rooms, a fully-equipped business center, comfortable lounges, service areas and all the audio and visual equipment you require. Our highly experienced and professional staff will see to it that your next meeting is nothing less than, well, historic. Blue Bell Country Club offers over 7,000 square feet of elegantly finished meeting space, with the same professional service and first class food and beverage that has been delivered for more than 25 years.

To ensure your next conference isn't all work and no play, experience motivating and empowering teambuilding activities, a farm to table restaurant, bar and lounge, art gallery, indoor swimming pool, fitness center and access to a championship golf course.

We invite you to become another success story in Normandy Farm's long tradition of them and enjoy our hospitality that's been nearly 300 years in the making.



Accommodations



FULL SERVICE HOTEL

Normandy Farm boasts 141 exquisitely appointed King and Double Queen hotel rooms and suites. In-room amenities include free Wi-Fi, Starbucks coffee, coffee maker and accessories, in-room cable, multiple USB outlets to charge devices, work areas, and more. The hotel's garden level features a beautiful indoor swimming pool with jacuzzi, a newly renovated 24-hour fitness center with treadmills, ellipticals, and free weights. The main hotel wing is ADA-compliant, with five rooms designated for those with physical challenges.

THE FARMHOUSE EXPERIENCE

Rich in history and once relevant to another era's lifestyle, our four enchanting Farmhouses welcome small and large groups to rent the entire house during your stay. The Full Farm House Experience is perfect for corporate groups to enjoy luxurious accommodations and wake up all in one place. All Farmhouse Experience rooms include refrigerators and microwaves. Select rooms feature jacuzzis or separate bath and shower, fireplaces, sitting rooms, work stations, and more. Take over the Carriage House, Manor House, East, or West Gate House, and receive the Cottage Comfort Station with all the fixins' to make your experience at Normandy feel like home... View full details at: NormandyFarm.com/FarmhouseExperience



FOOD & BEVERAGE

at "the farmer's daughter" Restaurant

The Farmer's Daughter is the culinary cornerstone of this historic property. She offers an unforgettable dining experience with an exceptional menu of Chef Mtele Abubakar's "Modern Farm Cooking". At The Farmer's Daughter, locally sourced ingredients are brought to life on the plate in the form of pure flavors and innovative dishes inspired by the seasons and harvests of our surrounding region. We aspire to give our guests a sense of personal connection to the farmers, brewers, cheese mongers, distillers, winemakers and charcuterie craftsmen who collectively help create an exceptional dining experience. Our expansive bar and fireside lounge follows a "fresh only" approach, creating all of the mixers and infusions in-house from local fruits and vegetables for an extensive list of creative cocktails.





MEETINGS JUST GOT MORE *Stimulating*



The International Association of Conference Centers, known as IACC, has developed standards that elevate the meeting experience to only the best-in-class conference venues in the world. By exceeding all of those rigorous standards, Normandy Farm is part of an elite group of the most innovative, forward-thinking and results-driven conference centers in the industry. The IACC standards include a wide range of criteria, such as specific lighting and ambient sound levels, use of ergonomically designed chairs with hard surfaced tables, high speed wired and wireless internet, on-site AV/IT specialists and designated conference planners, a central business center with a variety of equipment such as printers, laptops, copiers, and digital media, just to name a few. In all there are more than 30 specific standards Normandy Farm has exceeded to earn the IACC certification. Meeting planners and guests can have complete confidence when booking their next meeting or event, knowing we are focused on delivering the exceptional business experience.

CONFERENCE ROOMS & SERVICES

- Over 30,000 sq. ft. of IACC meeting space
- 17 meeting rooms and 2 ballrooms
- Acoustically engineered meeting rooms with individual climate controls, track-able wall surfaces, and 18 hour ergonomic seating
- Top of the line technology featuring CAT 6 Cabling, high speed internet, video conferencing and web casting capabilities, digital LCD projectors, full complement of the latest audio/visual equipment and professional IT & A/V techs on site
- 2nd Floor Art Gallery
- 113 hotel rooms and 28 guest suites
- Accommodates 5 to 500 guests
- Fun and creative team-building packages
- Golf & recreational facilities



the farmer's
daughter
RESTAURANT

LUNCH

DINNER

HAPPY HOUR

SUNDAY BRUNCH

MAKE YOUR NEXT MEETING ONE FOR THE HISTORY BOOKS!



Complete & Daily

MEETING PACKAGE

Daily and complete meetings at Normandy Farm include a dedicated Meeting Coordinator and all of the tools necessary to host a successful meeting in one convenient package.

MEETING PACKAGE INCLUDES

- Acoustically engineered General Session rooms
- Office Space & Business Center
- All meeting rooms include flip charts, markers, notepads, pens, and candies
- Deluxe hot breakfast buffet, lunch buffet, and salad bar, AM & PM snack breaks, with continuous refreshments all near your general session rooms
- 20% service charge
- **Complete Meeting Package (CMP) at Normandy Farm includes all of the DMP, plus dinner, and overnight package.**
- Technology in all rooms include:
 - LCD projector
 - High-speed wired and wireless internet access
 - VCR and DVD player
 - Podium, microphone, and sound system
 - On-site AV/IT specialist
 - Dedicated conference planner



BREAKFAST SELECTIONS

CHEF'S CHOICE BREAKFAST BUFFET:

Scrambled Eggs, Bacon, Sausage

(1) Potato Item (Lakte, Home Fries, or Hash Browns)

(1) Bread Item (French Toast, Pancakes, Cheese Blintz)

Oatmeal, Sliced Fruit, Cereal, Yogurts, Bagels, Pastry

BEVERAGES AVAILABLE ALL DAY:

Freshly Brewed Coffee, Assorted Tea Selection, Soft Drinks and Bottled Water

AM BREAK | CHEF'S CHOICE BUFFET

Whole Fruit, Yogurts, Bagels, Pastry, Breakfast Bars, Oatmeal, Cereal

LUNCH SELECTIONS

CHEF'S CHOICE LUNCH BUFFET:

Chicken Entree, Beef Entree, Fish Entree, Vegetarian Entree, (1)

Starch, (1) Vegetable, (1) Soup, Dessert Station, Salad Bar

PM BREAK | CHEF'S CHOICE DISPLAY

Candies, Bagged Chips, Hot Hors d'Oeuvres, Cold Hors d'Oeuvres, Dessert, Mixed Nuts



A PHILADELPHIA BUSINESS JOURNAL TOP MEETING SITE

Conference Center

CAPACITY & STYLE

CHERRY

- 12 Ppl, Conference
- 16 Ppl, U-Shape
- 24 Ppl, Classroom
- 30 Ppl, Pods
- 60 Ppl, Theater

HICKORY

- 12 Ppl, Conference
- 20 Ppl, U-Shape
- 30 Ppl, Classroom
- 30 Ppl, 6 Pods of 6
- 50 Ppl, Theater

HAWTHORN

- 14 Ppl, Conference
- 22 Ppl, U-Shape
- 42 Ppl, Classroom
- 36 Ppl, Pods
- 60 Ppl, Theater

BIRCH

- 12 Ppl, Conference
- 18 Ppl, U-Shape
- 30 Ppl, Classroom
- 30 Ppl, Pods
- 50 Ppl, Theater

CEDAR

- 16 Ppl, Conference
- 24 Ppl, U-Shape
- 36 Ppl, Pods
- 46 Ppl, Classroom
- 60 Ppl, Theater

OAK

- 16 Ppl, Conference
- 24 Ppl, U-Shape
- 48 Ppl, Pods
- 50 Ppl, Classroom
- 90 Ppl, Theater

PINE

- 16 Ppl, Conference
- 24 Ppl, U-Shape
- 34 Ppl, Double U-Shape
- 36 Ppl, Pods
- 40 Ppl, Classroom
- 100 Ppl, Theater

WILLOW

- 20 Ppl, Conference
- 34 Ppl, U-Shape
- 46 Ppl, Double U-Shape
- 72 Ppl, Pods
- 80 Ppl, Classroom
- 200 Ppl, Theater

Ash, Dogwood, Cypress, and Sycamore are breakouts with capacities between 4 and 12.

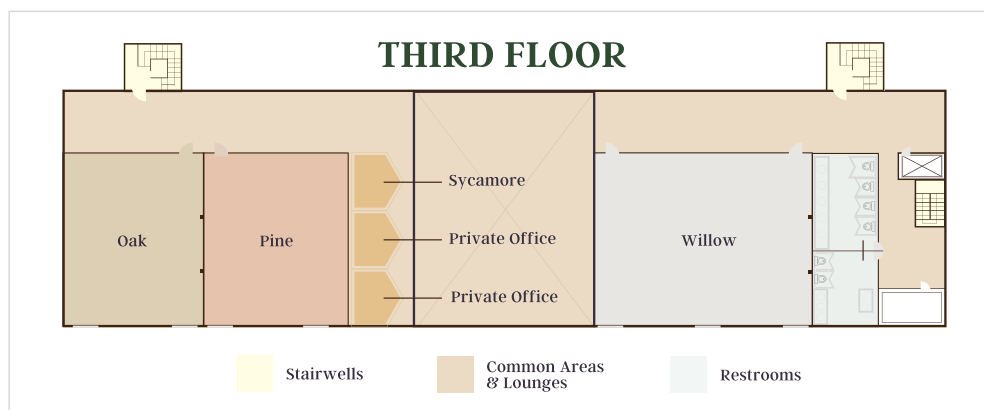
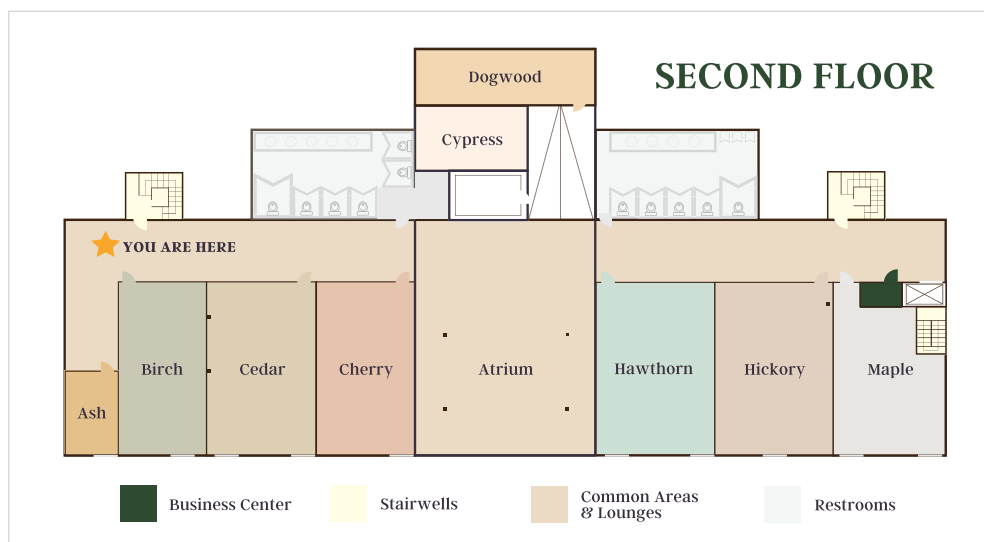

NORMANDY FARM BALLROOMS

SPECS	Grand	Silos
L x W	90' x 20'	50' x 60'
Ht	28' at peak	22' at peak
Sq Ft	6,100	3,000
STYLES		
Theater	550	130
Classroom	350	84
Banquet	450	175
Crescent	350	90

GRAND BALLROOM

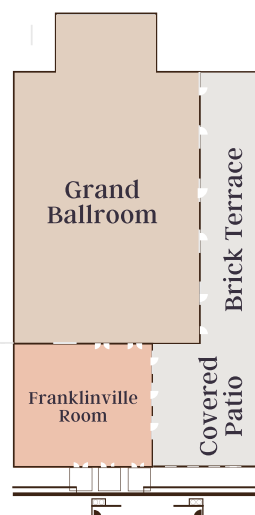

SILOS BALLROOM

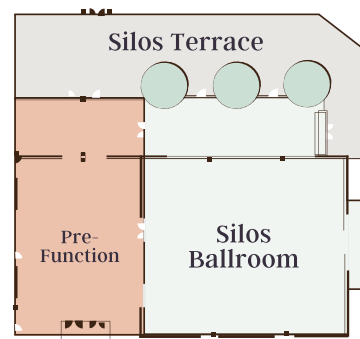

TERRACES

Directly adjacent to and accessible from each ballroom and pre-function area is a private terrace. The Grand Ballroom Terrace is 4,400 square feet and accommodates over 400 guests.



BLUE BELL Country Club

OFFER YOUR CONFEREES A CHANGE OF SCENERY WITHIN THE ENVIRONS OF A PRIVATE COUNTRY CLUB

Adjacent to Normandy Farm is our sister-facility, Blue Bell Country Club, which also offers everything you need to make your next meeting a great success—elegant facilities, exquisite food and beverage and first-class professional service—all in the relaxing environment of a private country club. Our magnificently appointed meeting and banquet rooms are warm and inviting and offer the perfect ambiance to keep your meeting professional and comfortable. Whether you are at Normandy Farm or Blue Bell Country Club, we invite you to combine golf with your event by scheduling a golf outing with us!



ROOM SPECS	PALMER	BIRKDALE	BALLROOM
Length x Width	29' x 40'	46' x 42'	90' x 50'
Height	11'6"	11'6"	13'6"
Sq Ft	700	1,940	4,500
STYLES			
Theater	30	80	300
Classroom	16	48	120
U-Shape	16	28	50
Conference	12	20 with AV	N/A
Banquet	30	80	300
Crescent	21	54	140

CHAMPIONSHIP GOLF

No conference would be complete without adding a relaxing round of golf to the program. Right across the way from Normandy Farm is its sister-facility, Blue Bell Country Club. Blue Bell Country Club is a private golf and country club nestled inside a prestigious, gated community. As a full-service facility, Blue Bell Country Club offers an unparalleled golfing experience with its Arnold Palmer-designed "Signature" golf course, first-class recreational amenities, and exquisite dining.

Testimonials

"Yours is a FIRST CLASS organization who put forth a phenomenal team effort. Please share with all who played an active role in making sure the Closets by Design team felt welcomed. The accommodations, the food, the WINE DINNER! – absolutely top notch.."

CLOSETS BY DESIGN



"I'm looking forward to repeating the experience with our DC and Chicago teams over the summer."

LE PAIN QUOTIDIEN



"THANK YOU for having staff that truly care, made customer service a priority, and put forth 100% effort during our entire 4 days on the property. When I say everyone...I truly mean EVERYONE! There was not a person that crossed my path that I didn't have a "can do attitude" and this just made for a great experience. Your farm to table dining is one that I need in my life EVERYDAY and the sweet treats were simply AMAZING!"

MAZARS USA

"Everyone raved about the food and service. The roominess of your facility is beyond expectations."

LIBERTY BELL CORROSION





TEAM BUILDING

Looking to add some skill (and thrill) to your next meeting? Our talented staff and professional partners will guide you to improve your culinary skills, investigate a murder, escape the room, launch axes at a bullseye, mix specialty cocktails, and much more!

Our menu of team building events promote leadership skills, cooperation, strategy, and the tenacity needed to exceed in the work force. These completely “hands-on” instructional classes may be held anytime during the day or evening and can be conveniently scheduled to meet your time table.

Pair it with a wide selection of food and beverage options and you’ve got One Historic Experience.

Where there's a whisk, there's a way.

Choose your event:

- **Culinary Classes**
 - Pan-Asian Cooking
 - BBQ Grilling
 - The Farmer's Market
 - Taste of the Islands
 - Italian Kitchen
- **Bakeshop Classes**
 - Bakers vs. Fakers
 - Dessert Flatbread Challenge
 - Make-A-Cake Challenge
 - Soft Pretzel Making Class
- **Wine Dinner**
- **Mixology 101**
- **Wacky Golf**
- **Murder Mystery Dinner**
- **Axe Throwing**
- **Escape The Room**
- **Game Show**
- **Artistic Expressions**

